

**KNAPHEIDE**  
SINCE 1848



FORD  
**ALUMINUM  
SERVICE BODIES**



# KNAPHEIDE ALUMINUM SERVICE BODIES

Aluminum service bodies from Knapheide feature a superior design and innovative construction.

Utilizing military-grade aluminum and structural adhesives are just a few of the features that place our aluminum service bodies far ahead of the competition.



## STANDARD ALUMINUM SERVICE BODIES

In order to provide customers with the utmost confidence in our aluminum service bodies, we put them through the most rigorous testing program in history. They were subjected to the harshest environments and applications possible in our lab, on proving grounds — and by real customers like you.

Choose a Knapheide Aluminum Service Body and you'll get corrosion resistance, increased payload, and an aluminum service bed that is just as durable as steel.

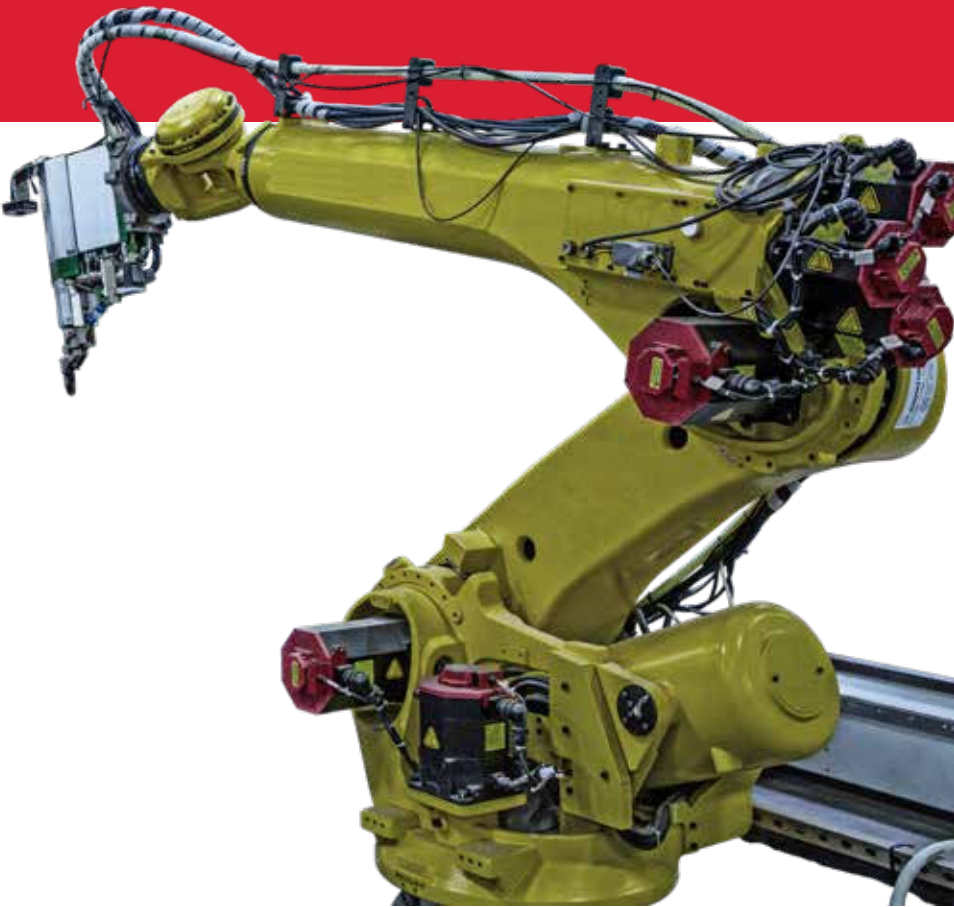

## AEROSPACE ASSEMBLY TECHNOLOGY

Assembled entirely from Grade 5 hardware and structural rivets that are coated specifically not to corrode with aluminum materials.

## POPULAR VOCATIONS



CONSTRUCTION



MUNICIPALITIES/  
UTILITIES



OIL/MINING/GAS



**A. FLOOR CONSTRUCTED OF RUGGED 6061 T6 ALUMINUM EXTRUSIONS AND EXCLUSIVE “RETURN FLANGE” FLOOR DESIGN**  
provides support and corrosion resistance

**B. ADJUSTABLE SECURITY RING STRIKERS**  
provide a weather-tight seal

**C. INTERIOR COVER**  
protects internal latch from damage

**D. SLAM-LOCK TAILGATE**  
with one-hand center release

**E. UPGRADED SURFACE MOUNT LIGHTING SYSTEM**  
features LED S/T/T and B/U, LED strobe option\* with (8) selectable patterns, and built-in reflectivity for additional safety\*\*

\*Additional wire harness required for strobe lights  
\*\*Lights covered by 3-year limited warranty



Note: Body may be shown with optional features.

## FEATURES NOT SHOWN

**CONSTRUCTED OF 6061 T6 & 5052 ALUMINUM**  
provides support and corrosion resistance

**QUICK-MOUNT INSTALLATION**  
allows for fast, safe mounting

**ALL ALUMINUM 6061 T6 UNDERSTRUCTURE**  
provides support and corrosion resistance

**AUTOMOTIVE-QUALITY ROTARY LATCHES**  
with easy open handler

**TPO FENDER SKIRT**

## COMPARTMENT FEATURES



**NITROGEN STRUT DOOR RETAINERS**  
on vertical compartment doors eliminate involuntary swing



**INSET DOOR FRAME DESIGN WITH DOUBLE TRAY ALUMINUM DOORS AND NEOPRENE SEALS**  
for weather-tight closing



**CONTINUOUS ALUMINUM HINGE WITH STAINLESS STEEL RODS**  
are pry-proof and corrosion-resistant



**INTERIOR LIGHT GUARDS**  
protect recessed lighting and wiring

## STANDARD SHELVING



**STREET AND CURB SIDE FRONT VERTICAL COMPARTMENTS**  
Two adjustable divider shelves and dividers, with a 250-lb. capacity (1st and 2nd vertical 132" bodies only)



**STREET AND CURB SIDE FULL HEIGHT REAR VERTICAL COMPARTMENTS**  
One adjustable divider shelf and dividers, with a 250-lb. capacity



**CURB SIDE HORIZONTAL COMPARTMENT**  
One adjustable divider shelf and dividers, with a 250-lb. capacity

60" tall bodies include an extra divider shelf in each compartment, including one in the streetside horizontal

COMPARTMENT CONFIGURATIONS



500 SERIES  
COMPARTMENTS

The 500 Series Service Bodies feature a horizontal compartment that stretches from the first vertical compartment to the end of the body with a small, rear lower compartment.



600 SERIES  
COMPARTMENTS

The 600 Series Service Bodies feature a horizontal compartment that is positioned over the wheel well and one vertical compartment in the front of the body and one at the rear of the body.



700 SERIES  
COMPARTMENTS

The 700 Series has 500 Series configuration on the curb side and 600 Series on the street side.



RAISED FRONT  
COMPARTMENTS

This configuration raises the curb side front vertical compartment to 60" tall, denoted by "60".



LOW PROFILE  
BODY

Low Profile Bodies, denoted by "LP", offer greater visibility from the cab while only sacrificing 4" of the body height compared to a standard Service Body.

FLIP TOP  
COMPARTMENTS

Flip Tops, denoted by "F", allow for greater internal storage, organization and flexibility. Knapheide Flip Tops have a slammable top lid door and a convenient one-hand release located in the horizontal compartment.



THREE-DRAWER UNIT



TWO-DRAWER UNIT

PLUS 50  
TRANSVERSE COMPARTMENTS

Plus 50 models feature a transverse compartment in the curb side front vertical extending to the street side compartment back. Plus 50 models have 50% more effective storage capacity. Models are denoted by "50".

Depending on body model, compartments have either two or three drawers, 59" or 69" long. All drawers are rated for 250-lb. and have dividers every 4".





## POPULAR OPTIONS

### BUMPERS

Knapheide bumpers are constructed with work in mind. Available in two configurations with KnapLiner coating for additional friction and durability.



**HITCH RECESS BUMPERS**



**STRAIGHT BUMPERS**

### UTILITY RACK

Adding a rack to your Service Body increases your storage space by getting your ladders and other long tools or equipment up and out of the way, making room to haul more items in your cargo area.

*1,000 lb. capacity - forklift loadable*





## POPULAR OPTIONS



**MASTER LOCKS**



**POWER LOCKS**



**FRONT STROBE**



**LED COMPARTMENT LIGHTS**



**GRAB HANDLES**



**CABLE STEPS**



**ALUMINUM DRAWERS**



**CARGO TIE-DOWNS**



**ROCK GUARDS**



**ALUMINUM TREAD PLATE TRIM KITS**



**PULL-OUT TRAY**



**MODULAR CAB GUARD**



**METER TRAY WITH HOLES**



**SINGLE POINT OR THREE POINT T-HANDLE**



**REAR ACCESS DOOR**

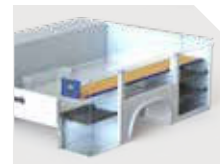

**REAR ACCESS DOOR WITH FULL-LENGTH SHELF**



**E-TRACK & ACCESSORIES**



**BOTTLE GAS RETAINER**



## REAR LIFTGATE



MODEL OPTIONS

31" CA SINGLE REAR WHEEL (FORD RANGER SERIES)

MODEL	TYPE	HEIGHT	WEIGHT
A672LP	Low Profile	36"	336 lb.
A672F	Flip Top	37.28"	465 lb.

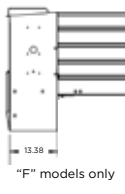
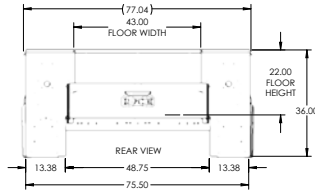
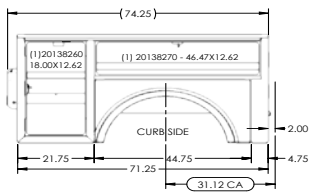

TRUCK	CAB	GVWR
R1A/R1E/R1F	Super	6,050 lb.

Note: Box Removal is only recommended on XL models without Co-Pilot360 option

40" CA SINGLE REAR WHEEL

MODEL	TYPE	HEIGHT	WEIGHT
A682	Standard	40"	508 lb.
A682LP	Low Profile	36"	482 lb.
A682F	Flip Top (L)	37.25"	561 lb.
A682F40	Flip Top (H)	41.25"	588 lb.

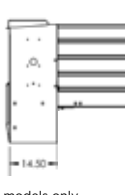
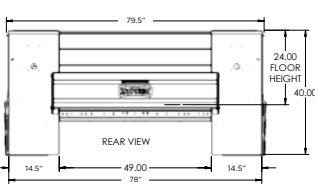
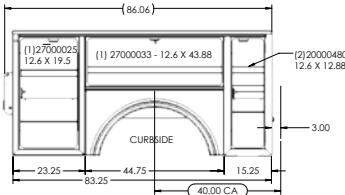

TRUCK	CAB	GVWR
X2A/X2B	Super	9,900/10,800 lb.
W2A/W2B	Crew	9,900/10,800 lb.
X3A/X3B	Super	9,900/11,500 lb.
W3A/W3B	Crew	9,900/11,500 lb.

56" CA SINGLE REAR WHEEL

MODEL	TYPE	HEIGHT	WEIGHT
A698	Standard	40"	588 lb.
A698LP	Low Profile	36"	559 lb.
A698F	Flip Top (L)	37.25"	652 lb.
A698F40	Flip Top (H)	41.25"	681 lb.
A698D38	Standard	40"	610 lb.
A698D38LP	Low Profile	36"	582 lb.
A698D38F	Flip Top	37.25"	696 lb.

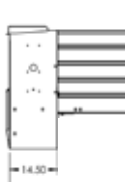
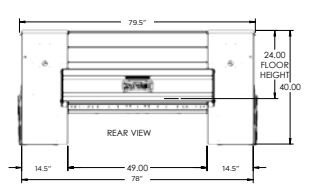
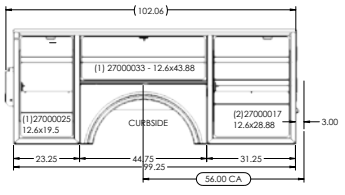

TRUCK	CAB	GVWR
F2A/F2B	Regular	9,900/10,600 lb.
X2A/X2B	Super	9,900/10,800 lb.
W2A/W2B	Crew	9,900/10,800 lb.
F3A/F3B	Regular	10,000/11,500 lb.
X3A/X3B	Super	10,000/11,500 lb.
W3A/W3B	Crew	10,000/11,500 lb.

56" CA DUAL REAR WHEEL

MODEL	TYPE	HEIGHT	WEIGHT
A698D54	Standard	40"	703 lb.
A698D54LP	Low Profile	36"	671 lb.
A698D54F	Flip Top (L)	37.25"	808 lb.
A698D54F40	Flip Top (H)	41.25"	836 lb.

TRUCK	CAB	GVWR
F3C/F3D	Regular	13,000/14,000 lb.
X3C/X3D	Super	13,000/14,000 lb.
W3C/W3D	Crew	13,000/14,000 lb.

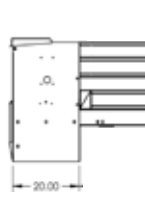
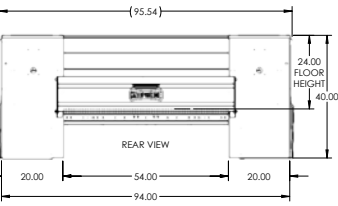
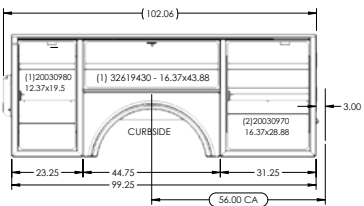

60" CA SINGLE REAR WHEEL

MODEL	TYPE	HEIGHT	WEIGHT
A6110	Standard	40"	635 lb.
A6110LP	Low Profile	36"	604 lb.
A6110F	Flip Top (L)	37.25"	705 lb.
A6110F40	Flip Top (H)	41.25"	737 lb.

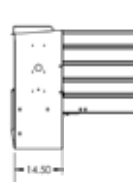
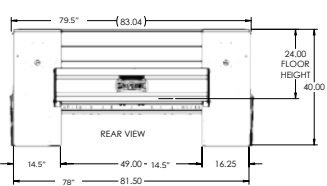
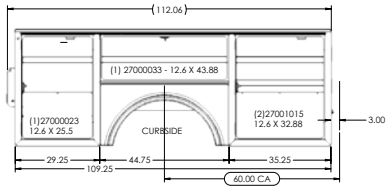

TRUCK	CAB	GVWR
F3E/F3F	Regular	9,800/11,500 lb.
X3E/X3F	Super	9,800/11,500 lb.
W3E/W3F	Crew	9,800/11,500 lb.

60" CA DUAL REAR WHEEL

MODEL	TYPE	HEIGHT	WEIGHT
A6110D54	Standard	40"	764 lb.
A6110D54LP	Low Profile	36"	725 lb.
A6110D54F	Flip Top (L)	37.25"	872 lb.
A6110D54F40	Flip Top (H)	41.25"	907 lb.
A6110D54H46	Standard	46"	747 lb.
A6110D54H60	Standard	60"	902 lb.

TRUCK	CAB	GVWR
F3G/F3H	Regular	14,000 lb.
X3G/X3H	Super	14,000 lb.
W3G/W3H	Crew	14,000 lb.
F4G/F4H	Regular	15,000/16,500 lb.
X4G/X4H	Super	15,000/16,500 lb.
W4G/W4H	Crew	15,000/16,500 lb.
F5G/F5H	Regular	17,500/19,500 lb.
X5G/X5H	Super	17,500/19,500 lb.
W5G/W5H	Crew	17,500/19,500 lb.

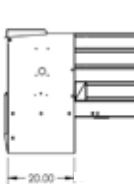
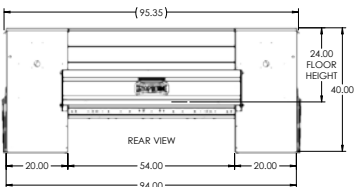
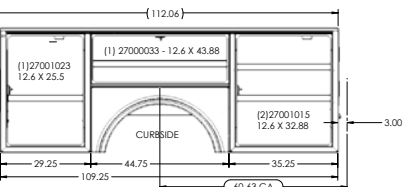

84" CA DUAL REAR WHEEL

MODEL	TYPE	HEIGHT	WEIGHT
A6132D54	Standard	40"	902 lb.
A6132D54LP	Low Profile	36"	862 lb.
A6132D54F	Flip Top (L)	37.25"	1,033 lb.
A6132D54F40	Flip Top (H)	41.25"	1,073 lb.
A6132D54H46	Standard	46"	888 lb.
A6132D54H60	Standard	60"	1,070 lb.

TRUCK	CAB	GVWR
F3G/F3H	Regular	14,000 lb.
F4G/F4H	Regular	15,000/16,500 lb.
X3G/X4H	Super	15,000/16,500 lb.
W4G/W4H	Crew	15,000/16,500 lb.
F5G/F5H	Regular	17,500/19,500 lb.
X5G/X5H	Super	17,500/19,500 lb.
W5G/W5H	Crew	17,500/19,500 lb.

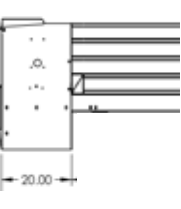
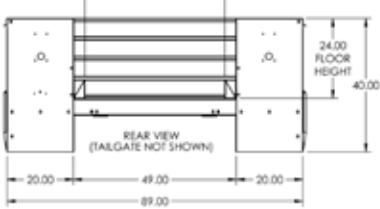
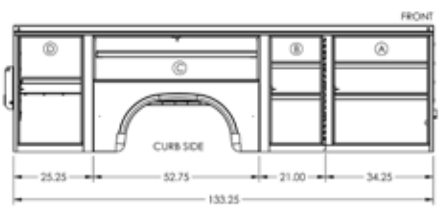

"F" models only



# COMMITMENT TO CORROSION RESISTANCE

Aluminum bodies are naturally corrosion resistant. Where steel fasteners are used, those fasteners are coated with “EcoGuard” to eliminate the interaction between the steel and aluminum.

This aluminum assembly method both allows us to create products with the highest level of corrosion resistance available.



FOLLOW US  
LIKE US  
TAG US



## TEN YEAR, LIMITED TIME WARRANTY



**NO RUST  
THROUGH**



**DOOR HINGES  
WILL NOT FAIL OR  
COME OFF BODY**



**LATCHES AND LOCK  
CYLINDERS WILL NOT  
FAIL TO OPERATE**



**SHELVES WILL NOT  
BEND UNDER MAX.  
LOAD OF 250 LBS.**

TO LEARN MORE VISIT  
[www.knapheide.com/warranty](http://www.knapheide.com/warranty)





## NEVER SETTLE

If you are going to be a leader, it takes more than building a high-quality product. It means never being totally satisfied with that product, no matter how high quality it may be. It requires constant vigilance and a willingness to take a chance on something new. And it means exceeding expectations every time. As the industry changes, one thing never will—our commitment to making customers like you as productive and efficient as possible. We know you don't settle, and we don't either. That's why we want you never to settle for anything less than Knapheide on the back of your truck.

**KNAPHEIDE. NEVER SETTLE.**



The Knapheide Manufacturing Company  
1848 Westphalia Strasse | Quincy, IL 62305  
**217-222-7131**  
**[www.knapheide.com](http://www.knapheide.com)**