

KNAPHEIDE
SINCE 1848

// FORD

KUVcc BODIES



KNAPHEIDE KUVcc BODIES

The style and function of a KUV, designed for a cab chassis: the KUVcc is built to get the job done.

Providing both enclosed cargo and internal compartment storage, the KUVcc gives you the most efficient and secure storage possible.

Get the use of a truck and function of a KUV all-in-one with the KUVcc.



REAR VIEW: CARGO AREA

Visit [knapheide.com/quote](https://www.knapheide.com/quote) and fill out the form to receive a quote and additional product information.

STANDARD FEATURES

- A** Double panel rear cargo doors lock and seal into the body frame. These 20-gauge galvanized steel doors have nitrogen gas struts and slam latches.
- B** Two conduit chutes to transport copper pipes, PVC, and conduit
- C** Master Locking System for piece of mind — locks down all of the side compartments in one move
- D** Includes 250-lb. capacity adjustable divider shelves comprised of spangled galvanized steel, with divider slots on 4" centers
- E** Vertical compartment doors employ double-spring over-center retainers for elimination of involuntary swing
- F** Neoprene door seals protect compartments from the weather
- G** Continuous stainless steel hinges are pry-proof and corrosion-resistant
- H** Features double-shell, 20-gauge, two-sided A-40 galvanized steel compartment doors
- I** Automotive-quality, rotary-style latches make opening and closing easy
- J** Features two-sided A-40 galvanized steel shell
- K** Flat panel space provides rolling billboard to promote business
- L** Two interior dome lights in cargo area with light switch inside the cargo doors
- M** Spacious cargo area for transporting oversized tools and equipment
- N** 9"x30" glass window in front bulkhead positioned to line up with the cab rear window for visibility
- O** Upgraded surface mount lighting system features LED S/T/T and B/U, LED strobe option* with (8) selectable patterns, and built-in reflectivity for additional safety**
*Additional wire harness required for strobe lights
 **Covered under 3-year warranty

Other features:

- All compartments can be locked independently for maximum security
- Interior light guards provide protection for recessed lighting and wiring package
- Electrodeposition prime-paint system provides superior corrosion resistance
- Complete undercoating provides an additional layer of corrosion protection



POPULAR OPTIONS



**POWER
LOCKS**



**CODEABLE
PADLOCK**



**UPPER SIDE
GLASS**



**REAR VISION
CAMERA**

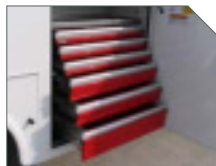

**ALUMINUM
DRAWERS**



SORTIMO



**REAR DOOR
WINDOWS**



**KNAPLINER
REAR BUMPER**



**PULL OUT
TRAY**



**POWER
LIFTGATE**
*Not available on
SRW models*



**CLASS V
RECEIVER
HITCH**



**MECHANICS
VISE
BRACKET**
Vise sold separately



SPITZLIFT

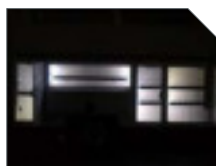

**LED
COMPARTMENT
LIGHTING**



**3 BOW
LADDER
RACK**

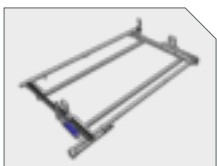

**DROP-DOWN
LADDER
RACK**
Prime Design

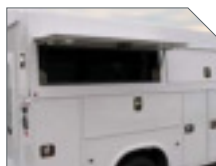

**SIDE ACCESS
DOOR**



**SIDE MOUNT
LADDER
RACK**

// 56" CA SINGLE REAR WHEEL

MODEL	BODY LENGTH	BODY HEIGHT	BODY WIDTH	COMPARTMENT DEPTH	CLEAR DOOR WIDTH	CLEAR DOOR HEIGHT	INTERIOR CLEAR HEIGHT	BODY WEIGHT
KC96U1478	97.25"	62"	78"	14.5"	44.5"	38.1"	44.5"	1,571 lb.
KC96L1478	97.25"	68"	78"	14.5"	44.5"	41.1"	50.5"	1,691 lb.
KC96M1478	97.25"	78"	78"	14.5"	44.5"	50.5"	60.5"	1,714 lb.

APPLICABLE CHASSIS	CAB	WHEELBASE	GVWR	EXCEPTIONS 10,000 & UNDER
X2A	Super	164.2"	9,600/10,000 lb.	Gas Only
F3A/F3B	Regular	141.6"	10,400/11,200 lb.	-
X3A/X3B	Super	164.2"	10,200/11,500 lb.	-
W3A/W3B	Crew	176"	10,200/11,500 lb.	-

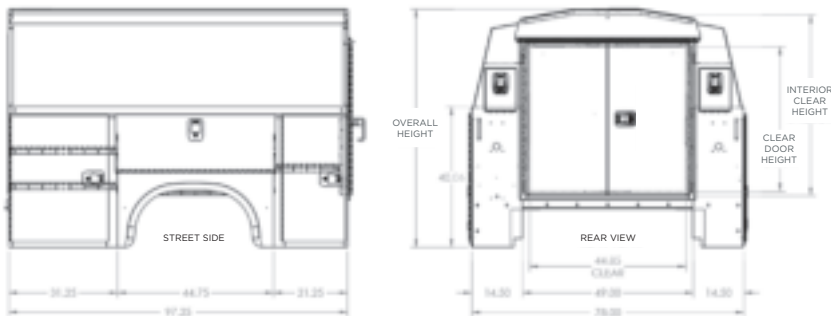

// 56" CA DUAL REAR WHEEL

MODEL	BODY LENGTH	BODY HEIGHT	BODY WIDTH	COMPARTMENT DEPTH	CLEAR DOOR WIDTH	CLEAR DOOR HEIGHT	INTERIOR CLEAR HEIGHT	BODY WEIGHT
KC96U2094	97.25"	62"	94"	20"	49.5"	38.1"	44.5"	1,686 lb.
KC96L2094	97.25"	68"	94"	20"	49.5"	41.1"	50.5"	1,824 lb.
KC96M2094	97.25"	78"	94"	20"	49.5"	50.5"	60.5"	1,847 lb.
KC96H2094	97.25"	90"	94"	20"	49.5"	63.1"	72.5"	1,965 lb.

APPLICABLE CHASSIS	CAB	WHEELBASE	GVWR
F3C/F3D	Regular	141.6"	13,000/14,000 lb.
X3C/X3D	Super	164.2"	13,000/14,000 lb.
W3C/W3D	Crew	176"	13,000/14,000 lb.



// 60" CA SINGLE REAR WHEEL

MODEL	BODY LENGTH	BODY HEIGHT	BODY WIDTH	COMPARTMENT DEPTH	CLEAR DOOR WIDTH	CLEAR DOOR HEIGHT	INTERIOR CLEAR HEIGHT	BODY WEIGHT
KC108U1478	107.25"	62"	78"	14.5"	44.5"	38.1"	44.5"	1,592 lb.
KC108L1478	107.25"	68"	78"	14.5"	44.5"	41.1"	50.5"	1,717 lb.
KC108M1478	107.25"	78"	78"	14.5"	44.5"	50.5"	60.5"	1,743 lb.

APPLICABLE CHASSIS	CAB	WHEELBASE	GVWR	EXCEPTIONS 10,000 & UNDER
F3E/F3F	Regular	145.3"	9,800/11,000 lb.	Gas 4x2/4x4
X3E/X3F	Super	167.9"	9,800/11,500 lb.	-
W3E/W3F	Crew	179.8"	9,800/11,000 lb.	-

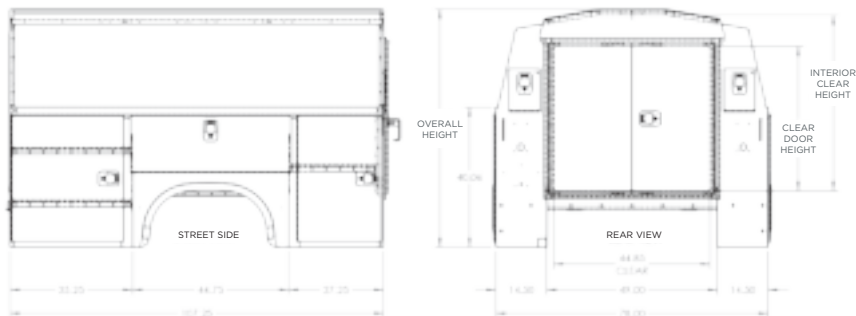

// 60" CA DUAL REAR WHEEL

MODEL	BODY LENGTH	BODY HEIGHT	BODY WIDTH	COMPARTMENT DEPTH	CLEAR DOOR WIDTH	CLEAR DOOR HEIGHT	INTERIOR CLEAR HEIGHT	BODY WEIGHT
KC108L2094	107.25"	68"	94"	20"	49.5"	41.1"	50.5"	2,026 lb.
KC108M2094	107.25"	78"	94"	20"	49.5"	50.5"	60.5"	2,045 lb.
KC108H2094	107.25"	90"	94"	20"	49.5"	63.1"	72.5"	2,365 lb.

APPLICABLE CHASSIS	CAB	WHEELBASE	GVWR
F3G/F3H	Regular	145.3"	13,700/14,000 lb.
X3G/X3H	Super	167.9"	14,000 lb.
W3G/W3H	Crew	179.8"	14,000 lb.
F4G/F4H	Regular	145.3"	15,000/16,500 lb.
X4G/X4H	Super	167.9"	15,000/16,500 lb.
W4G/W4H	Crew	179.8"	15,000/16,500 lb.
F5G/F5H	Regular	145.3"	17,500/19,500 lb.
X5G/X5H	Super	167.9"	17,500/19,500 lb.
W5G/W5H	Crew	179.8"	17,500/19,500 lb.

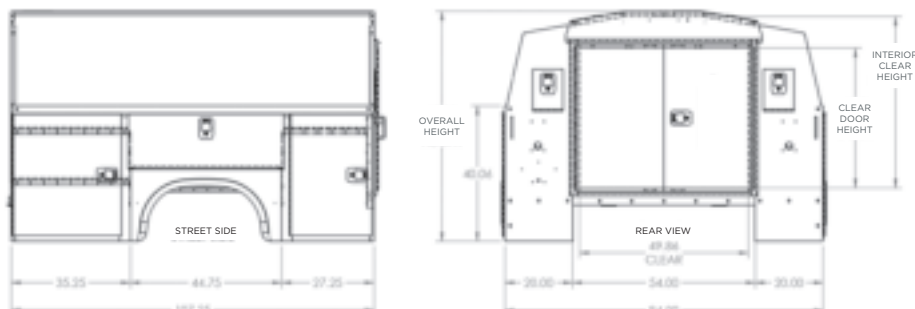

// 84" CA DUAL REAR WHEEL

MODEL	BODY LENGTH	BODY HEIGHT	BODY WIDTH	COMPARTMENT DEPTH	CLEAR DOOR WIDTH	CLEAR DOOR HEIGHT	INTERIOR CLEAR HEIGHT	BODY WEIGHT
KC132L2094	133.25"	68"	94"	20"	49.5"	41.1"	50.5"	2,439 lb.
KC132M2094	133.25"	78"	94"	20"	49.5"	50.5"	60.5"	2,465 lb.
KC132H2094	133.25"	90"	94"	20"	49.5"	63.1"	72.5"	2,585 lb.

APPLICABLE CHASSIS	CAB	WHEELBASE	GVWR
F3G/F3H	Regular	169.3"	14,000 lb.
F4G/F4H	Regular	169.3"	15,000/16,500 lb.
X4G/X4H	Super	191.9"	15,000/16,500 lb.
W4G/W4H	Crew	203.8"	15,000/16,500 lb.
F5G/F5H	Regular	169.3"	17,500/19,500 lb.
X5G/X5H	Super	191.9"	17,500/19,500 lb.
W5G/W5H	Crew	203.8"	17,500/19,500 lb.

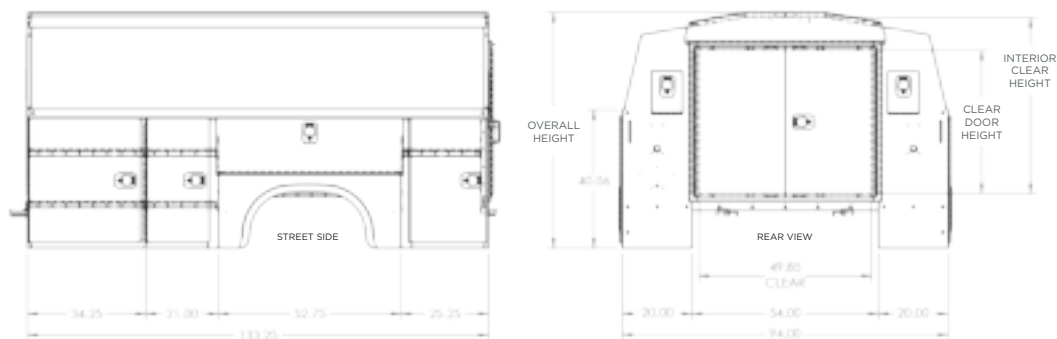

// 108" CA DUAL REAR WHEEL

MODEL	BODY LENGTH	BODY HEIGHT	BODY WIDTH	COMPARTMENT DEPTH	CLEAR DOOR WIDTH	CLEAR DOOR HEIGHT	INTERIOR CLEAR HEIGHT	BODY WEIGHT
KC157H2094	157.25"	90"	94"	20"	49.5"	63.1"	72.5"	2,960 lb.

APPLICABLE CHASSIS	CAB	WHEELBASE	GVWR
F4G/F4H	Regular	193.3"	15,000/16,500 lb.
F5G/F5H	Regular	193.3"	17,500/19,500 lb.

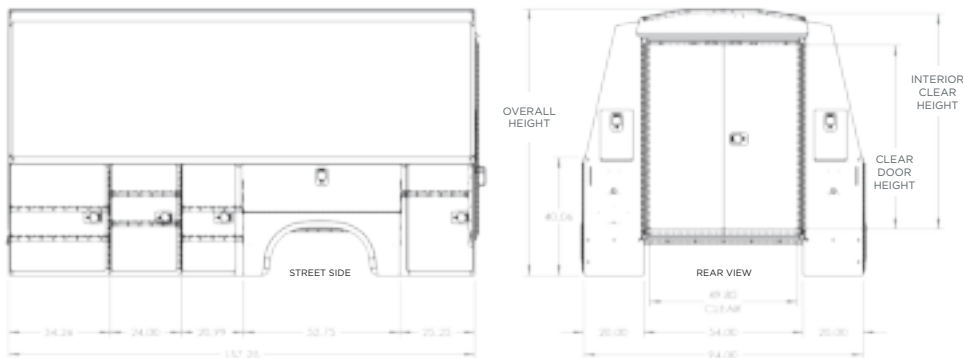

// 120" CA DUAL REAR WHEEL

MODEL	BODY LENGTH	BODY HEIGHT	BODY WIDTH	COMPARTMENT DEPTH	CLEAR DOOR WIDTH	CLEAR DOOR HEIGHT	INTERIOR CLEAR HEIGHT	BODY WEIGHT
KC169H2094	169.25"	90"	94"	20"	49.5"	63.1"	72.5"	3,148 lb.

APPLICABLE CHASSIS	CAB	WHEELBASE	GVWR
F4G/F4H	Regular	205.3"	15,000/16,500 lb.
F5G/F5H	Regular	205.3"	17,500/19,500 lb.







COMMITMENT TO CORROSION RESISTANCE

Corrosion won't be a concern when you buy quality Knapheide products. To give you the best corrosion protection, we utilize a state-of-the-art, custom-designed, 12-step, SST cathodic electrodeposition finishing system, called "E-Coat."

It bonds prime paint to steel by an electroplating process to give you a superior coat of primer, resulting in better corrosion protection compared to spraying methods.

This system allows us to create products with the highest level of corrosion resistance available.

NEVER SETTLE

If you are going to be a leader, it takes more than building a high-quality product. It means never being totally satisfied with that product, no matter how high quality it may be. It requires constant vigilance and a willingness to take a chance on something new. And it means exceeding expectations every time. As the industry changes, one thing never will—our commitment to making customers like you as productive and efficient as possible. We know you don't settle, and we don't either. That's why we want you never to settle for anything less than Knapheide on the back of your truck.

Knapheide. Never settle.

SIX-YEAR, LIMITED WARRANTY



NO RUST
THROUGH



DOOR HINGES WILL
NOT FAIL OR COME
OFF BODY



LATCHES AND LOCK
CYLINDERS WILL NOT
FAIL TO OPERATE



SHELVES WILL NOT
BEND UNDER MAX.
LOAD OF 250 LBS.

Visit www.knapheide.com/warranty for more information.



The Knapheide Manufacturing Company
1848 Westphalia Strasse | Quincy, IL 62305

217-222-7131
www.knapheide.com

KNAPHEIDE
SINCE 1848